

Steelcase Amia

Amia

Design Story: Understated Versatility

Amia's hidden little secret:

Notice what you don't see with Amia? Amia was intentionally designed to hide the LiveLumbar™ back technology to create a quiet, streamlined look.

The LiveLumbar system offers height adjustable spring force in the lumbar region that actively supports the lower back to keep your spine in the healthy s-shape as you sit. Amia is extremely versatile with two back options and consistently among our best-selling chairs.

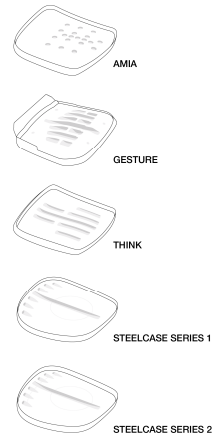

Fun Fact: Amia was the first chair to be designed with “adaptive bolstering,” which is strategic coring in the seat foam that conforms to the body distributing the user’s weight to create a pressure-free sit. This innovation dubbed Amia the “most comfortable” seat and this practice was applied to all our high-performance seating moving forward (Leap does not include this feature).

